

LINE SUPT.: Jim Shelquist
#19 Pickup

[Click Here](#)
for Subs 1-4

[Click Here](#) [Click Here](#)
for Subs 5-8 for Subs 9-12

CREW AREA 2
MAPS 4 THROUGH 39

CREW LEAD LINEMAN: Kurt Tharaldson
CREW: Jon Anderson
Ryne Midstokke

MAP NO.	TOWNSHIP NAME
57	ALLIANCE
13	ANDOVER
30	ANTHONY
56	BARNESVILLE
6	BYGLAND
49A	CROMWELL
55	ELKTON
54	ELMWOOD
12	FAIRFAX
42	FELTON
7	FISHER
44	FLOWING
40	GEORGETOWN
51	GLYNDON
25	GOOD HOPE
28	GREEN MEADOW
43	HAGEN
31	HALSTAD
17	HAMMOND
50A	HAWLEY
33	HEGNE
32	HENDRUM
58	HOLY CROSS
23	HUBBARD
56A	HUMBOLDT
5	HUNTSVILLE
46	KRAGNES
53	KURTZ
35	LAKE IDA
39	LEE
26	LOCKHART
8	LOWELL
38	MARY
34	MCDONALDSVILLE
48	MOLAND
52	MOORHEAD
45	MORKEN
4	NESBIT
47	OAKPORT
29	PLEASANT VIEW
21	REIS
5	RHINEHART
50	RIVERTON
36	ROCKWELL
14	ROOME
18	RUSSIA
22	SCANDIA
24	SHELLY
55A	SKREE
27	SPRING CREEK
49	SPRING PRAIRIE
15	TYNSID
41	VIDING
16	VINELAND
16F	VINELAND
37	WINCHESTER

CITY INDEX	
CITY	MAP
ADA (MUNI)	34
AVERILL (XCELL)	49
BAKER (XCELL)	57
BARNESVILLE (MUNI)	56
BELTRAMI (OTP)	21
BORUP (XCELL)	37
CLIMAX (OTP)	16
COMSTOCK (XCELL)	58
CROOKSTON (OTP)	8
DILWORTH (XCELL/RRV)	52
DOWNER (RRV)	55
EAST GRAND FORKS (MUNI)	5
ELDRED ((OTP/RRV)	14
FELTON (XCELL)	42
FISHER (OTP)	7
GEORGETOWN (RRV)	40
GLYNDON (XCELL/RRV)	51
HADLER (RRV)	29
HALSTAD (MUNI)	31
HAWLEY (MUNI)	50A
HENDRUM (RRV)	32
LOCKHART (OTP)	26
MALLORY (RRV)	5
MOORHEAD (MUNI)	52
NIELSVILLE (MUNI/OTP)	23
PERLEY (RRV)	39
RUSTAD (RRV)	53
SABIN (XCELL)	54
SHELLY (MUNI/OTP)	24

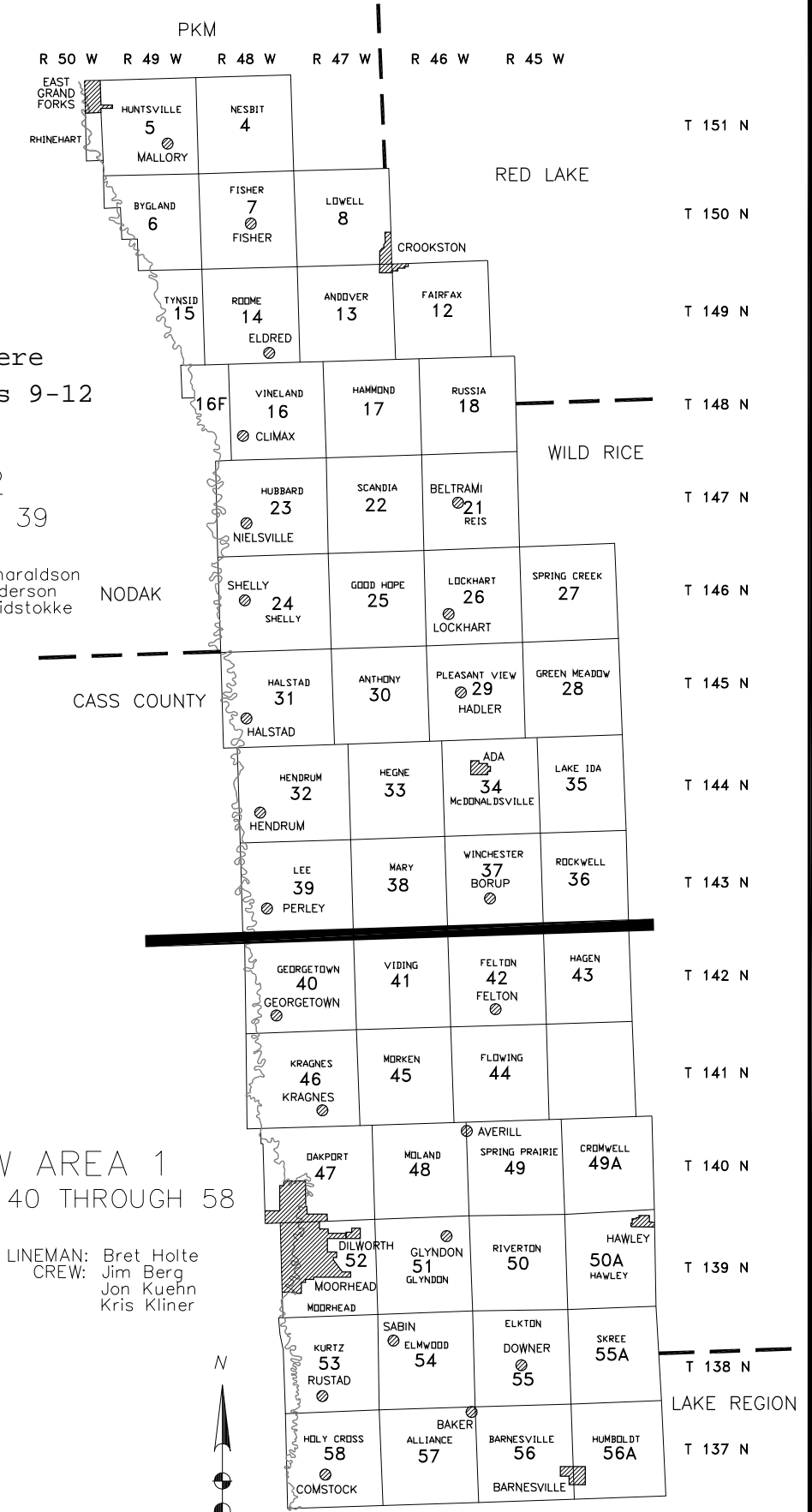

CREW AREA 1
MAPS 40 THROUGH 58

CREW LEAD LINEMAN: Bret Holte
CREW: Jim Berg
Jon Kuehn
Kris Kliner

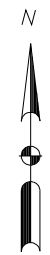

[Click Here for Entire Consumer Info File](#)